

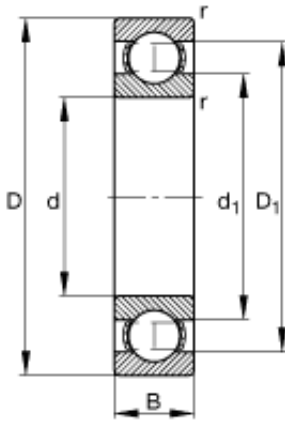

BEARING BOWER CORP.

100 mm x 215 mm x 47 mm FAG 6320 Single Row Ball Bearings

Bearing No. 6320



6320 Bearing 2D drawings and 3D CAD models

Size	100x215x47 mm
Bore Diameter	100 mm
Outer Diameter	215 mm
Width	47 mm
d	100 mm
D	215 mm
B	47 mm
D ₁	179 mm
D _{a max}	201 mm
d ₁	138,6 mm
d _{a min}	114 mm
r _{a max}	2,5 mm
r _{min}	3 mm
m	7,67 kg / Weight
C _r	174000 N / Dynamic load rating (radial)
C _{0r}	135000 N / Static load rating (radial)
n _G	4250 1/min / Limiting speed
n _B	4650 1/min / Reference speed
C _{ur}	7400 N / Fatigue limit load, radial